

INDEX	OL-51093
REV. LEVEL	0
SHEET	1 OF 1

TOSHIBA/HOUSTON

**QUARRY DUTY
TOTALLY-ENCLOSED FAN-COOLED
HORIZONTAL FOOT-MOUNTED**

**Fr. 5010UZ
6-POLE STD 350 & 400 HP
6-POLE EQP III 400HP
4-POLE STD 500 HP**

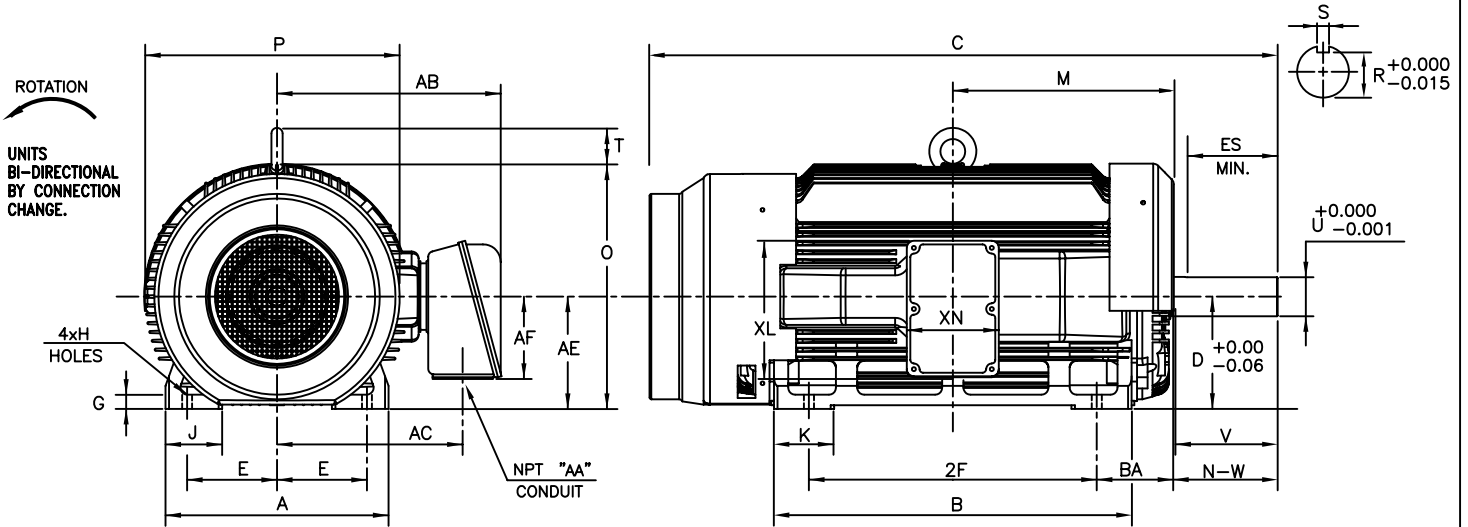

UNITS: INCHES

FRAME SIZE	MOUNTING				CONDUIT BOX							
	E	2F	H	BA	AA	AB	AC	AE	AF	XL	XN	
5010UZ	10.00	32.0	1.12	8.50	4.00	24.88	20.66	12.5	9.15	15.16	10.24	

FRAME SIZE	MOTOR DIMENSIONS										
	A	B	C	D	G	J	K	M	O	P	T
5010UZ	24.8	39.8	69.9	12.50	1.6	6.3	6.7	24.6	27.2	28.4	4.3

FRAME SIZE	SHAFT EXTENSION			KEY SEAT			BEARINGS		MAXIMUM WEIGHT
	N-W	V	U	R	S	ES	LS	OS	
5010UZ	11.625	11.38	4.375	3.817	1.000	10.03	NU324C3	6320C3	4905 lbs.

NOTES:

1. DIMENSION V REPRESENTS LENGTH OF STRAIGHT PART OF SHAFT.
2. CONDUIT BOX MAY BE ROTATED IN 90° INCREMENTS AND MAY BE MOUNTED ON OPPOSITE SIDE ON SPECIAL ORDER.
3. "UZ" KEY DIMENSIONS EQUAL S x S x 10.00
"US" KEY DIMENSIONS EQUAL S x S x 5.00 (MOTOR SUPPLIED WITH KEY)
4. MOTOR WEIGHT SHOWN IS MAXIMUM HORSEPOWER IN FRAME.

ALL DATA SUBJECT TO CHANGE WITHOUT NOTICE.
FOR CONSTRUCTION USE ONLY CERTIFIED DATA.

CERTIFIED DATA

CUSTOMER: _____ P.O. NO.: _____ TAG NO.: _____

MOTOR MODEL NO.: _____ TOSHIBA FILE NO.: _____

HP: _____ RPM (SYN.): _____ VOLTAGE: _____ Hz: _____

FRAME SIZE: _____ LOG NO.: _____ LOG REV. LEVEL: _____

REMARKS: _____

PER: _____ ISSUE DATE: _____ SUPERSEDES: _____