

INDEX	SAS000897
REV. LEVEL	3
SHEET	1 OF 1

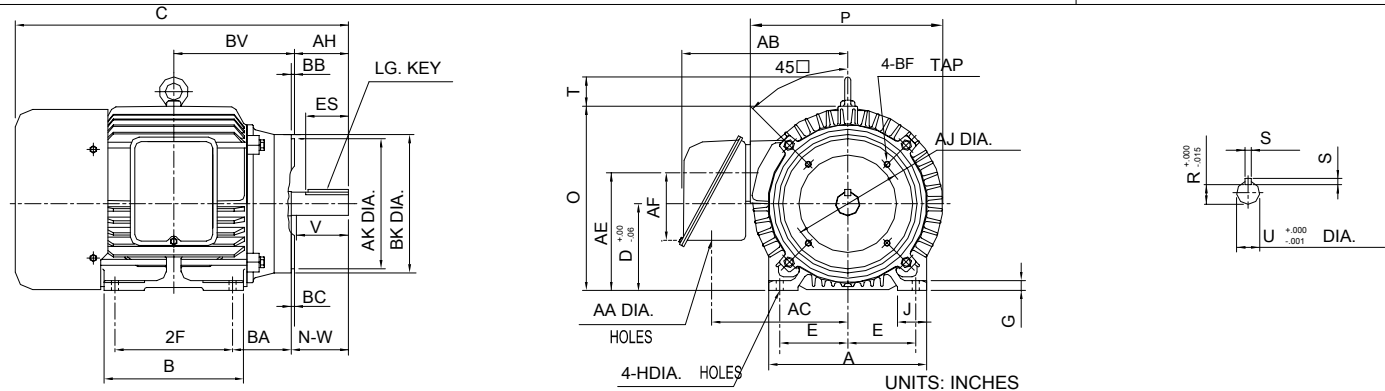

FRAME SIZE	MOUNTING				FLANGE						
	E	2F	H	BA	AJ	AK	BB	BC	BK	BF TAP	BV
284TC/TSC	5.50	9.50	0.53	4.75	9.000	10.500	0.25	0.25	11.25	1/2"-13UNC	9.24
286TC/TSC	5.50	11.00	0.53	4.75	9.000	10.500	0.25	0.25	11.25	1/2"-13UNC	10.50

FRAME SIZE	MOTOR DIMENSIONS									CONDUIT BOX						
	A	B	C	D	G	J	O	T	P	AA	AB	AC	AE	AF	XL	XN
284TC	12.76	11.26	26.9	7.00	0.79	2.36	14.87	2.7	15.67	2.48	13.98	11.0	9.56	5.51	—	—
286TC	12.76	11.26	28.4	7.00	0.79	2.36	14.87	2.7	15.67	2.48	13.98	11.0	9.56	5.51	—	—
284TSC	12.76	11.26	25.53	7.00	0.79	2.36	14.87	2.7	15.67	2.48	13.98	11.0	9.56	5.51	—	—
286TSC	12.76	11.26	27.03	7.00	0.79	2.36	14.87	2.7	15.67	2.48	13.98	11.0	9.56	5.51	—	—

FRAME SIZE	SHAFT EXTENSION				KEY SEAT			BEARINGS		MAXIMUM WEIGHT
	AH	N-W	V	U	R	S	ES	LS	OS	
284TC/286TC	4.38	4.62	4.38	1.875	1.591	0.500	3.28	6310ZZ	6210ZZ	427 lbs.
284TSC/286TSC	3.00	3.25	3.00	1.625	1.416	0.375	1.91	6310ZZ	6210ZZ	409 lbs.

- NOTES:
- DIMENSION V REPRESENTS LENGTH OF STRAIGHT PART OF SHAFT.
 - CONDUIT BOX MAY BE ROTATED IN 90° INCREMENTS AND MAY BE MOUNTED ON OPPOSITE SIDE ON SPECIAL ORDER.
 - "T" KEY DIMENSIONS EQUAL S x S x 3.25
"TS" KEY DIMENSIONS EQUAL S x S x 1.88 (MOTOR SUPPLIED WITH KEY)
 - MOTOR WEIGHT SHOWN IS MAXIMUM HORSEPOWER IN FRAME.

ALL DATA SUBJECT TO CHANGE WITHOUT NOTICE FOR CONSTRUCTION USE ONLY CERTIFIED DATA

CERTIFIED DATA

CUSTOMER: _____ P.O. NO.: _____ TAG NO.: _____
 MOTOR MODEL NO.: _____ TOSHIBA FILE NO.: _____
 HP: _____ RPM (SYN.): _____ VOLTAGE: _____ Hz: _____
 FRAME SIZE: _____ LOG NO.: _____ LOG REV. LEVEL: _____
 REMARKS: _____

 PER: _____ ISSUE DATE: _____ SUPERSEDES: _____

TOSHIBA/HOUSTON

**TOTALLY-ENCLOSED
FAN-COOLED
FOOT-MOUNTED
WITH C-FACE FLANGE
Fr. 284TC-286TC
Fr. 284TSC-286TSC**

SAS000897