

| | |
|------------|-------------|
| INDEX | MDSL0031-13 |
| REV. LEVEL | 2 |
| SHEET | 1 OF 1 |

TOSHIBA/HOUSTON
EQP III "XS" & "841"

TOTALLY-ENCLOSED FAN-COOLED
HORIZONTAL FOOT-MOUNTED
PREMIUM EFFICIENCY SEVERE DUTY

4-6 POLE
DIRECT COUPLE
Fr. 447TS

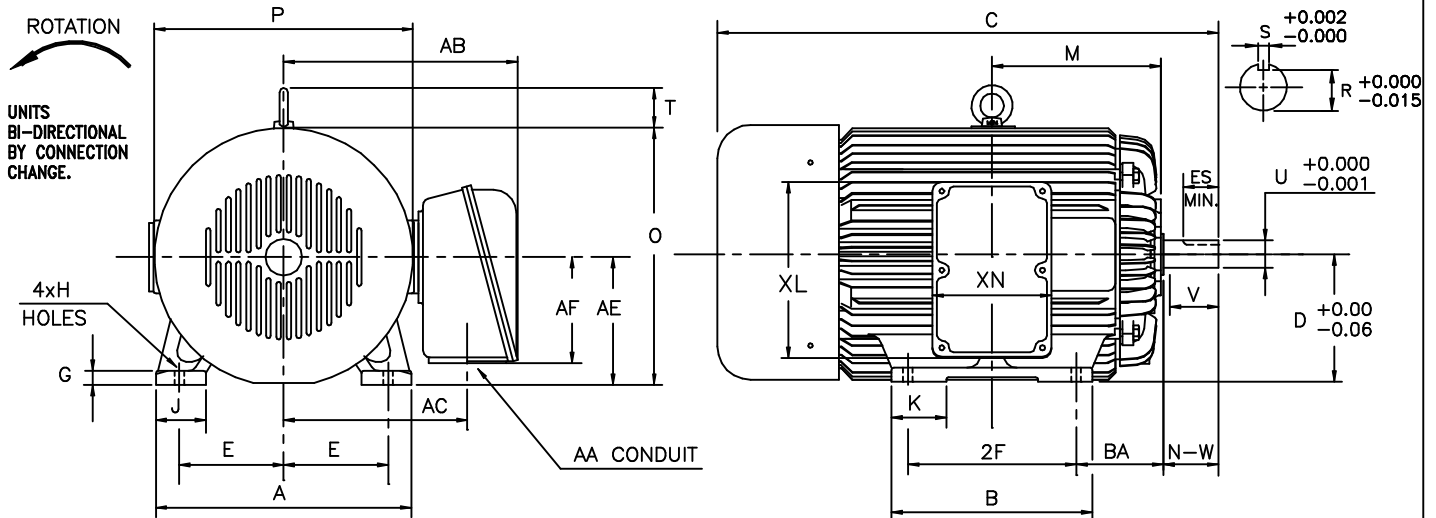

UNITS: INCHES

| FRAME SIZE | MOUNTING | | | | CONDUIT BOX | | | | | | |
|------------|----------|------|------|------|-------------|------|------|------|-----|------|------|
| | E | 2F | H | BA | AA | AB | AC | AE | AF | XL | XN |
| 447TS | 9.00 | 20.0 | 0.81 | 7.50 | 3.00 | 20.1 | 15.8 | 11.0 | 9.2 | 15.2 | 10.2 |

| FRAME SIZE | MOTOR DIMENSIONS | | | | | | | | | | |
|------------|------------------|------|------|-------|-----|-----|-----|------|------|------|-----|
| | A | B | C | D | G | J | K | M | O | P | T |
| 447TS | 22.0 | 22.8 | 48.7 | 11.00 | 1.2 | 4.3 | 4.7 | 17.3 | 22.1 | 22.4 | 3.9 |

| FRAME SIZE | SHAFT EXTENSION | | | KEY SEAT | | | BEARINGS | | MAXIMUM WEIGHT |
|------------|-----------------|------|-------|----------|-------|------|----------|--------|----------------|
| | N-W | V | U | R | S | ES | LS | OS | |
| 447TS | 4.75 | 4.50 | 2.375 | 2.021 | 0.625 | 3.03 | 6318C3 | 6318C3 | 2267 lbs. |

NOTES:

1. DIMENSION V REPRESENTS LENGTH OF STRAIGHT PART OF SHAFT.
2. CONDUIT BOX MAY BE ROTATED IN 90° INCREMENTS AND MAY BE MOUNTED ON OPPOSITE SIDE ON SPECIAL ORDER.
3. KEY DIMENSIONS EQUAL S x S x 3.00 (MOTOR SUPPLIED WITH KEY)
4. MOTOR WEIGHT SHOWN IS MAXIMUM HORSEPOWER IN FRAME.

ALL DATA SUBJECT TO CHANGE WITHOUT NOTICE.
 FOR CONSTRUCTION USE ONLY CERTIFIED DATA.

CERTIFIED DATA

CUSTOMER: _____ P.O. NO.: _____ TAG NO.: _____

MOTOR MODEL NO.: _____ TOSHIBA FILE NO.: _____

HP: _____ RPM (SYN.): _____ VOLTAGE: _____ Hz: _____

FRAME SIZE: _____ LOG NO.: _____ LOG REV. LEVEL: _____

REMARKS: _____

PER: _____ ISSUE DATE: _____ SUPERSEDES: _____