

INDEX	MDSL0042-02
REV. LEVEL	1
SHEET	1 OF 1

TOSHIBA/HOUSTON

EXPLOSION PROOF
HORIZONTAL FOOT-MOUNTED
F-2 ASSEMBLY

HAZARDOUS LOCATION Fr. 182T-184T
CLASS I GROUP D
CLASS II GROUP E, F, AND G

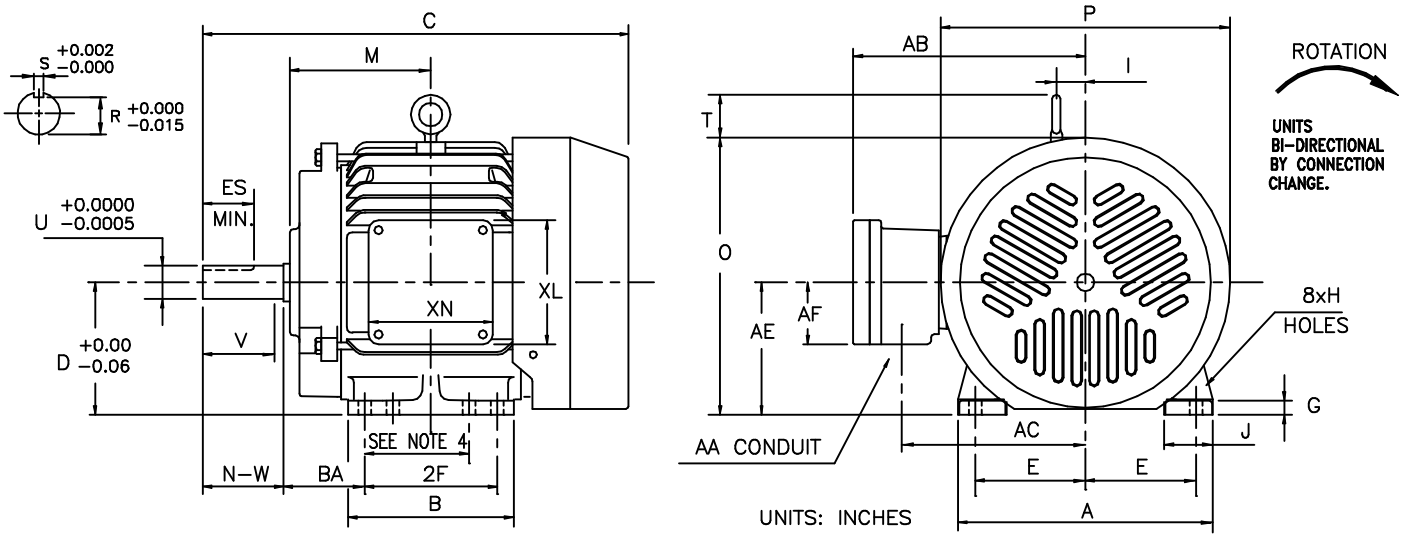

FRAME SIZE	MOUNTING				CONDUIT BOX						
	E	2F	H	BA	AA	AB	AC	AE	AF	XL	XN
182T	3.75	4.50	0.44	2.75	0.75	7.9	6.4	4.5	2.1	4.2	4.2
184T	3.75	5.50	0.44	2.75	0.75	7.9	6.4	4.5	2.1	4.2	4.2

FRAME SIZE	MOTOR DIMENSIONS										
	A	B	C	D	G	I	J	M	O	P	T
182T/184T	8.7	6.6	15.5	4.50	0.5	1.0	1.6	5.3	9.4	9.8	1.7

FRAME SIZE	SHAFT EXTENSION			KEY SEAT			BEARINGS		MAXIMUM WEIGHT
	N-W	V	U	R	S	ES	LS	OS	
182T/184T	2.75	2.50	1.125	0.986	0.250	1.78	6306UU	6306UU	120 lbs.

- NOTES:
1. DIMENSION V REPRESENTS LENGTH OF STRAIGHT PART OF SHAFT.
 2. CONDUIT BOX MAY BE ROTATED IN 90° INCREMENTS AND MAY BE MOUNTED ON OPPOSITE SIDE ON SPECIAL ORDER.
 3. KEY DIMENSIONS EQUAL S x S x 1.75 (MOTOR SUPPLIED WITH KEY)
 4. DIMENSIONS FOR 182T MOUNTING EQUAL (2F) LOCATED IN 182T SIDE VIEW.
 5. MOTOR WEIGHT SHOWN IS MAXIMUM HORSEPOWER IN FRAME.

ALL DATA SUBJECT TO CHANGE WITHOUT NOTICE.
FOR CONSTRUCTION USE ONLY CERTIFIED DATA.

CERTIFIED DATA

CUSTOMER: _____ P.O. NO.: _____ TAG NO.: _____
 MOTOR MODEL NO.: _____ TOSHIBA FILE NO.: _____
 HP: _____ RPM (SYN.): _____ VOLTAGE: _____ Hz: _____
 FRAME SIZE: _____ LOG NO.: _____ LOG REV. LEVEL: _____
 REMARKS: _____
 PER: _____ ISSUE DATE: _____ SUPERSEDES: _____