

INDEX	MDSL0051-13
REV. LEVEL	4
SHEET	1 OF 1

TOSHIBA/HOUSTON DRIP-PROOF HORIZONTAL FOOT-MOUNTED

Fr. 449
DIRECT COUPLE
2 POLE

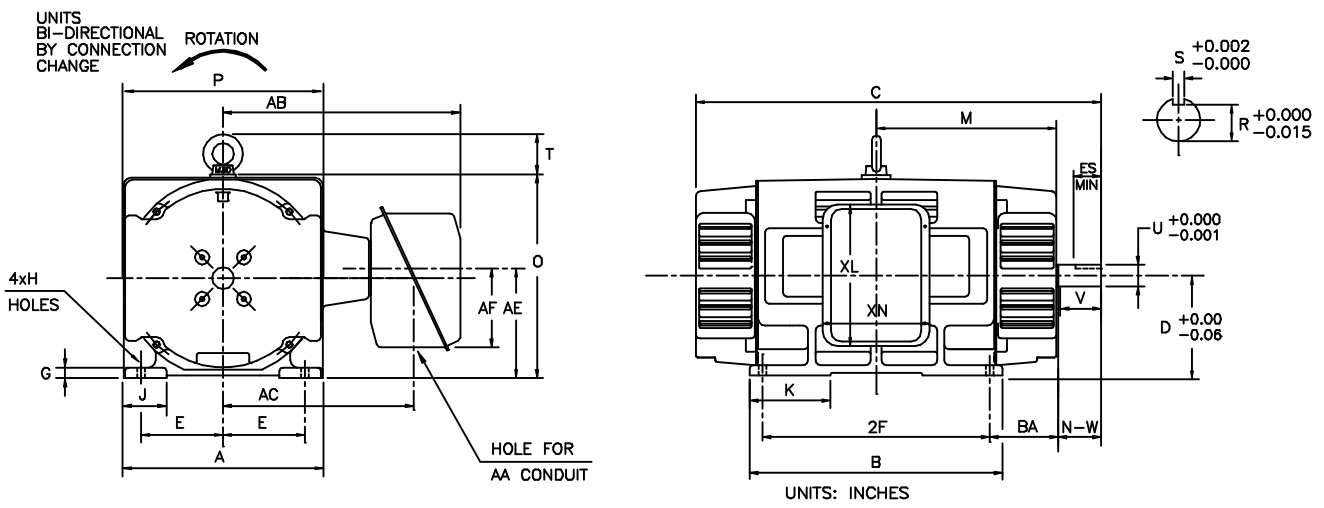

FRAME SIZE	MOUNTING				CONDUIT BOX						
	E	2F	H	BA	AA	AB	AC	AE	AF	XL	XN
449TS	9.00	25.00	0.81	7.50	3.0	26.0	21.3	12.05	8.7	15.50	11.7

FRAME SIZE	MOTOR DIMENSIONS										
	A	B	C	D	G	J	K	M	O	P	T
449TS	22.0	27.8	44.75	11.00	1.16	4.53	8.86	20.0	22.44	22.0	4.33

FRAME SIZE	SHAFT EXTENSION			KEY SEAT			BEARINGS		MAXIMUM WEIGHT
	N-W	V	U	R	S	ES	LS	OS	
449TS	4.75	4.50	2.375	2.021	.625	3.03	6313C3	6313C3	2575 lbs.

ALL DATA SUBJECT TO CHANGE WITHOUT NOTICE.
FOR CONSTRUCTION USE ONLY CERTIFIED DATA.

- NOTES:
1. DIMENSION V REPRESENTS LENGTH OF STRAIGHT PART OF SHAFT
 2. CONDUIT BOX WILL BE MOUNTED ON OPPOSITE SIDE UPON REQUEST. CONDUIT BOX MAY BE ROTATED IN 90° INCREMENTS
 3. KEY DIMENSIONS EQUAL S x S x 3.00 (MOTOR SUPPLIED WITH KEY)
 4. MOTOR WEIGHT SHOWN IS MAXIMUM HORSEPOWER IN FRAME.

CERTIFIED DATA

CUSTOMER: _____ P.O. NO.: _____ TAG NO.: _____

MOTOR MODEL NO.: _____ TOSHIBA FILE NO.: _____

HP: _____ RPM (SYN.): _____ VOLTAGE: _____ Hz: _____

FRAME SIZE: _____ LOG NO.: _____ LOG REV. LEVEL: _____

REMARKS: _____

PER: _____ ISSUE DATE: _____ SUPERSEDES: _____